

Installation Guide

Date | 20.11.2018
Release No. | 1

Equipment required

- Mechanical fixings - countersunk self-tapping screws 6g x 1" (6g x 25mm)
Note: Screws must be countersunk so the Tredsafe insert will adhere over the top once installed.
- Battery operated cordless drill with hammer function (or electric drill if preferred)
- Phillips screwdriver bits
- Hammer
- Wipes or cloth rags
- Denatured or Isopropyl alcohol
- For Concrete Substrates:
 - Nylon concrete plugs 3/16"/5g x 1" (5g x 25mm)
 - Concrete drill bit size 3/16" (5mm) wide with drill depth minimum 1 1/2" (38mm) for strength

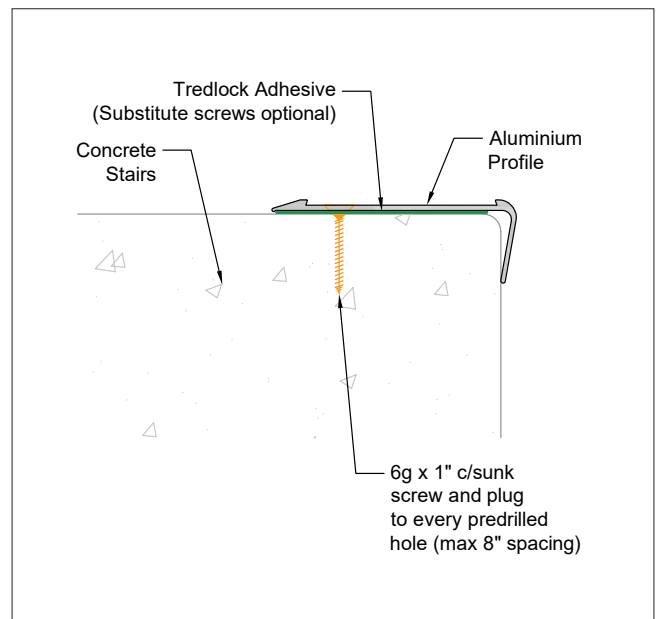

Profile Installation

Step 1 Measure and cut the profile to the required length. Profiles are pre-drilled in our factory, but lengths shorter than two pre-drilled screw holes require a hole to be manually drilled and countersunk on site. Maximum spacing of screw fixings is every 8 inches and maximum of 2 1/2 inches from the ends of the profile.

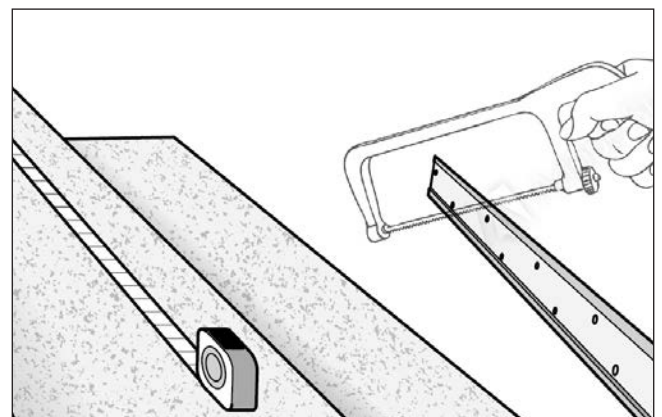

For Concrete Substrates go to Step 2.
For all other substrates go to Step 5.

For Concrete Substrates

- Step 2** Locate the profile against the stair nose and use a pencil or marker to mark the location for the pre-drilled countersunk holes.

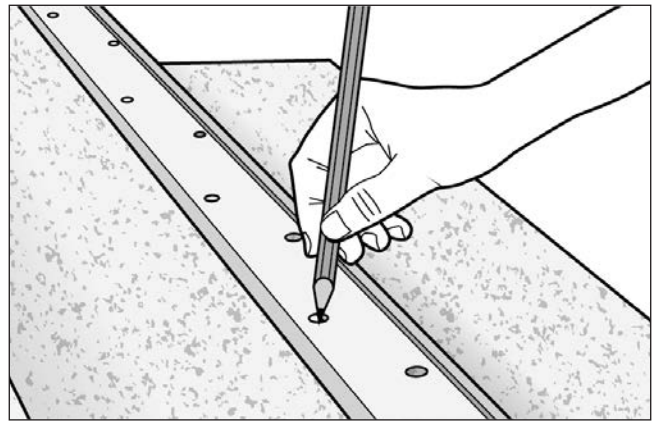

- Step 3** Remove the profile and drill the concrete plug holes with the 3/16" (5mm) masonry drill bit.

Tip: It may help to measure and mark the depth to drill and wrap tape around the masonry bit to ensure the correct and uniform depth.

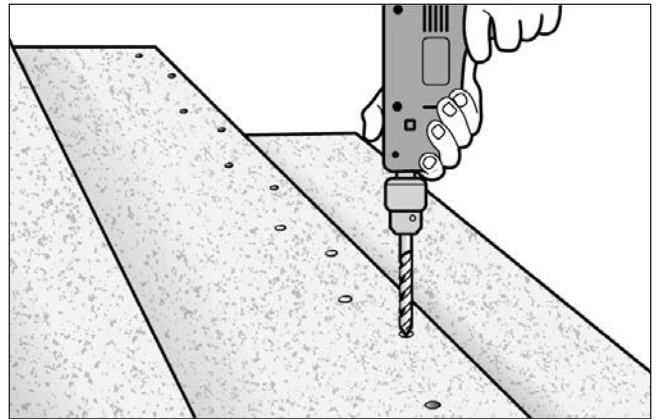

- Step 4** Clean away the concrete dust from drilling and push in by hand or lightly tap the plugs into the holes with a hammer.



For All Surfaces

- Step 5** Place the cut profile length into its fixed position on the stair nosing edge (aligning with the drilled holes if it is a concrete substrate).

- Step 6** Screw fix the profile using the 6g x 1" (25mm) countersunk self-tapping screws with the cordless drill and correct screwdriver bit.

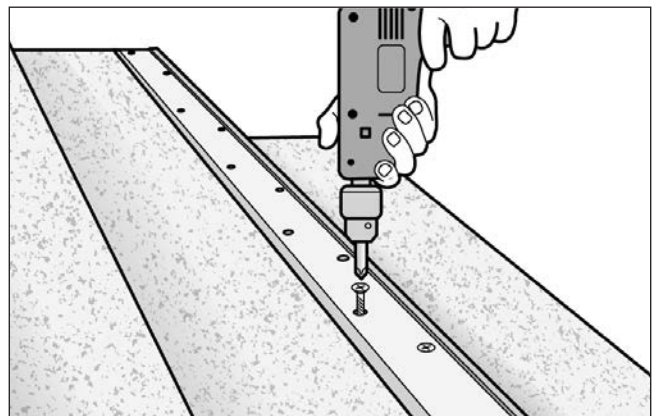

Once all screws are fastened, the profile installation is complete and the insert can be installed.

Installation of Adhesive Insert

Step 1

- Ensure the aluminium channel is clean from dust, residues and debris. Wipe down with a cleaning solvent (Isopropyl Alcohol or similar).

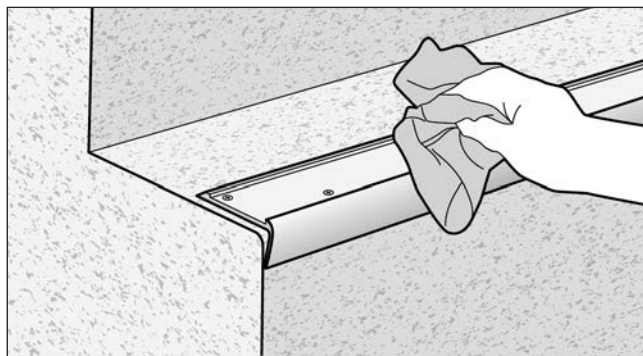

Step 2

- Precut the Insert to your required length.

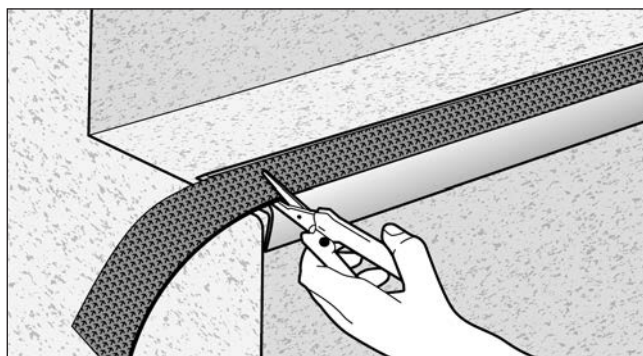

Step 3

- Remove the adhesive backing liner from the Tredsafe Insert.

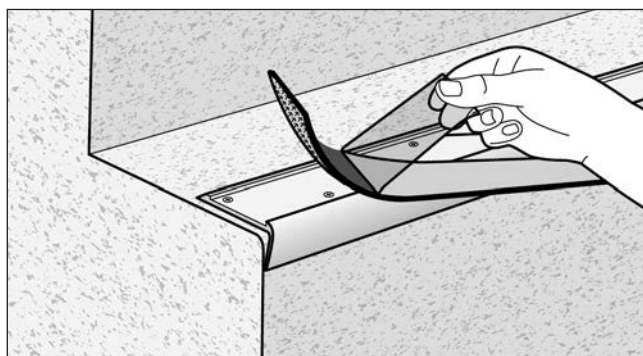

Step 4

- Install by placing the Insert into the nosing and pressing into place without undue stretching.

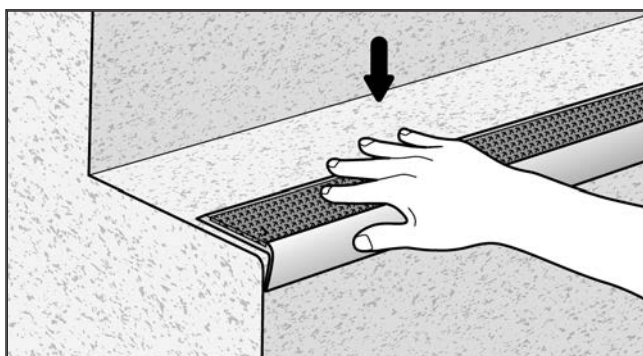

Step 5

- Once in place, roll over the Insert to ensure consistent adhesion and a secure bond.
- Please take care not to stretch the Insert when rolling.

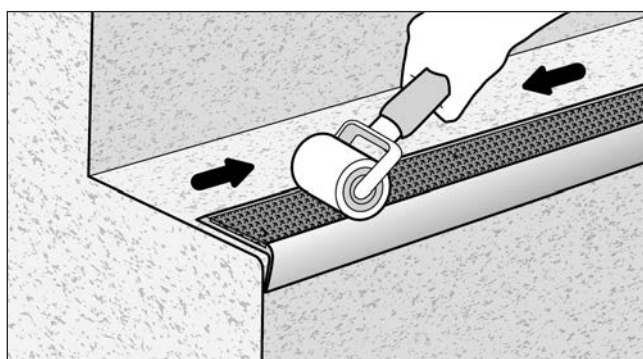

Installation is now complete.